

## SPECIAL FEATURES

- ECONOMICAL
- EASY TO INSTALL
- RANGES 0 TO 6000mm WC

## APPLICATIONS

DRAUGHT APPLICATION



## SPECIFICATIONS

**STANDARD VERSION : 150 x 78 mm, 200 x 104 mm**

Accuracy	: ± 2.5% of F.S.
Ambient temperature	: -15°C to + 60°C
Process temperature	: -20°C to + 60°C

Case	: Steel, black powder Coated
Ring	: Steel, black powder Coated
Element	: Copper Alloy
Movement	: Copper Alloy
Socket	: Copper Alloy
Dial	: Aluminium Black graduation of white background
Pointer	: Aluminium Black coloured externally zero adjustable
Window	: Acrylic
Gasket	: Neoprene

## DIMENSIONS - STANDARD VERSION

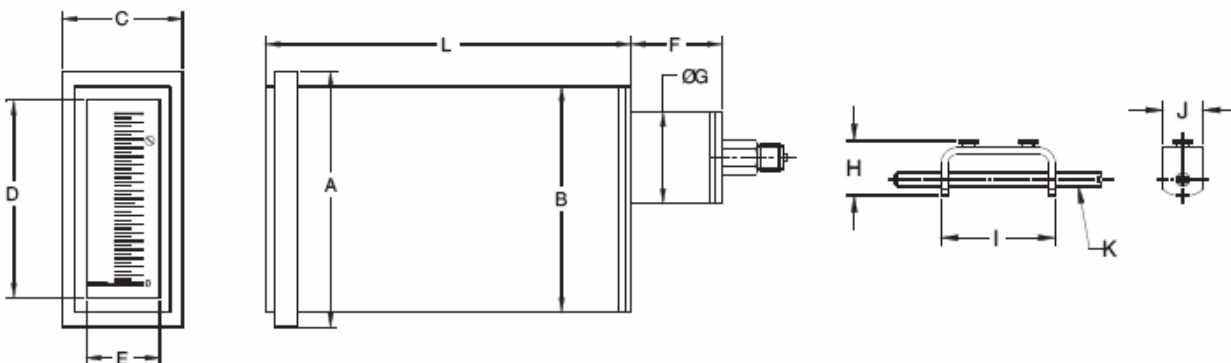

NS	A	B	C	D	E	F	ØG	L	H	I	J	K	Weight in gram (With Box)
150x78	150	87	78	118	48	66	64	110	21	50	17.5	M6	1500.0
200x104	200	137	104	118	48	66	64	178	21	50	17.5	M6	1900.0

## RANGE TABLE

Note : Manufacturer offers National / International Scales like kPa, Mpa, bar, psi, kg/cm<sup>2</sup>, mbar, mmWC, inWC & Dual Scale like kPa with psi, kPa with bar, bar with psi or Equivalent scales as per the requirement can be provided on request

Following are the example tables for mmWC Scale.

## PRESSURE RANGE

SINGLE SCALE - mmWC			
RANGE	RANGE	RANGE	RANGE (ADDITIONAL)
0/50	0/6000	-400/0	0/800
0/100	-50/0	-600/0	-800/800
0/200	-100/0	-25/25	
0/250	-200/0	-50/50	
0/400	-250/0	-100/100	
0/600	-400/0	-125/125	
0/1000	-600/0	-200/200	
0/1600	-1000/0	-500/500	
0/2500	-1600/0	-1000/1000	
0/4000	-2500/0	-2000/2000	

## HOW TO ORDER

### BASIC MODEL

### CODE

K L

### NOMINAL SIZE

150 x 78 mm 200 x 104 mm

### TYPE OF MOUNTING

5 FLUSH PANEL WITH BACK ENTRY

### GAUGE CONNECTION

2NM 1/4" NPT (M) STANDARD

2BM 1/4" BSP (M)

4BM 1/2" BSP (M)

4NM 1/2" NPT (M)

Note : Connections like PT/PF/Flaired /UNF/G/R etc.can be provided on request.  
Non standard connections can be provided through adaptors.

### RANGE

REFER TABLES

### OPTIONS

FOR NON STANDARD PRODUCTS/OPTIONAL ITEMS, PLEASE CONTACT FACTORY FOR DELIVERY AND MINIMUM QUANTITY OF ORDER.

PW FIVE POINT CALIBRATION CERTIFICATE

RH CUSTOM DESIGNED DIAL

SX SS TAG PLATE

BH

K

5

2BM

0-100  
mmWC

SX

### Ordering Example:

BH - K - 5 - 2BM - 0/100mmWC - SX

Note : • Due to continuous improvement, the specification may vary from time to time.