

Thread connection
Flange connection

Model 095
Model 096

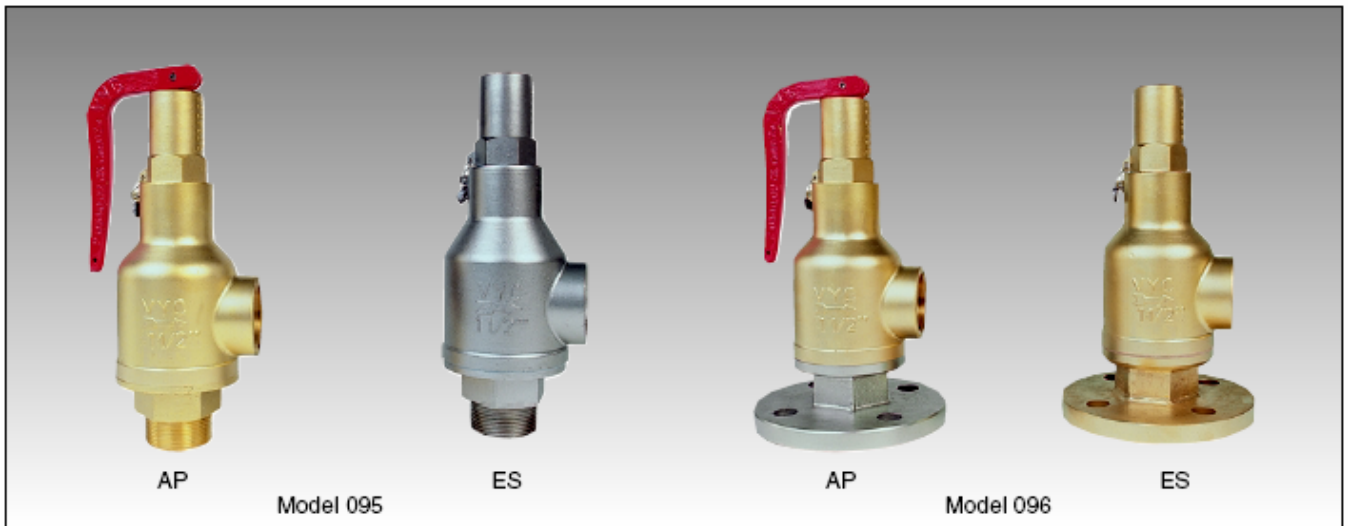

The valve works as an automatic pressure releasing regulator activated by the static pressure existing at the entrance to the valve and is characterized by its ability to open proportional to the pressure increase.

Desing in line with the "AD-MERKBLATT A2 Specifications sheet" and "Technical safety instructions for TRD-421 steam boilers".

In accordance with UNE 9-100-86 "Proportional safety valve" (Steam boilers).

Complies with the requirements of "Regulation for pressurised equipment ITC-MIE-AP..." (Proportional safety valve).

Component test stamp: TÜV Rheinland (German technical supervision authority).

Licence N°:

Specifications

- Model AP open cap with lever.
- Model ES closed cap without lever.
- 90° angular flow.
- Activated by direct action helicoid spring.
- Simplicity of construction ensuring minimum maintenance.
- Materials carefully selected for their resistance to corrosion.
- Internal body designed to offer favourable flow profile.
- Seat and sealing disk balanced, making them extremely tightness, even exceeding DIN-3230 requeriments. Page 3.
- Great discharge capacity.
- Guarantees absolute opening and closing precision.
- Equipped with draining screws for removing condensation. (For $d_0 > 45,20$ mm.).
- Orientation of the lever by rotation.
- All the valves are supplied sealed at the set pressure requested, simulating operational conditions, and are vigorously tested.
- All components are numbered, registered and checked. If requested in advance, material, casting, test and efficiency certificates will be enclosed with the valve.

IMPORTANT

1.- Silicone's rubber, Fluorelastomer (Vitón) seals, PTFE (Teflón)... etc., achieving leakage levels less than:

$$0,3 \times 10^{-8} \frac{\text{Pa cm}^3}{\text{sec.}}$$

The ranges of application allow certain flexibility although we recommend limiting them to:

FLUID		RANGE OF APPLICATIONS OF THE SEALS					
		SET PRESSURE IN bar					
		0,2	1,5	3,5	4,0	6,0	25,0
Saturated steam		S	V				T
Liquids and gases		S		V		T	
SEALS		TEMPERATURE IN °C					
		ACCORDING TO MANUFACTURERS		RECOMMENDED BY VYC			
		MINIMUM	MAXIMUM	MINIMUM	MAXIMUM		
Silicone's rubber	S	-60	+200	-50	+115		
Fluorelastomer (Vitón)	V	-40	+250	-30	+150		
PTFE (Teflón)	T	-285	+280	-80	+230 (1)		

(1) For temperatures exceeding 230°C apply metallic seal only.

Depending on demand:

- Buna-nitrils seals, Butyl, Natural rubber, E.P.D.M., Chlorosulphonate polyethylene (Hypalon), Neoprene, etc.
- Seal metal by metal.
- Electrical contact indicating open/closed.
- Other connections.
- Possibility of manufacture in other types of material, for special operating conditions (high temperatures, fluids, etc.).
- Totally free of oil and grease, to work with oxygen, avoiding possible fire risks (UV-Oxygen-VBG62).

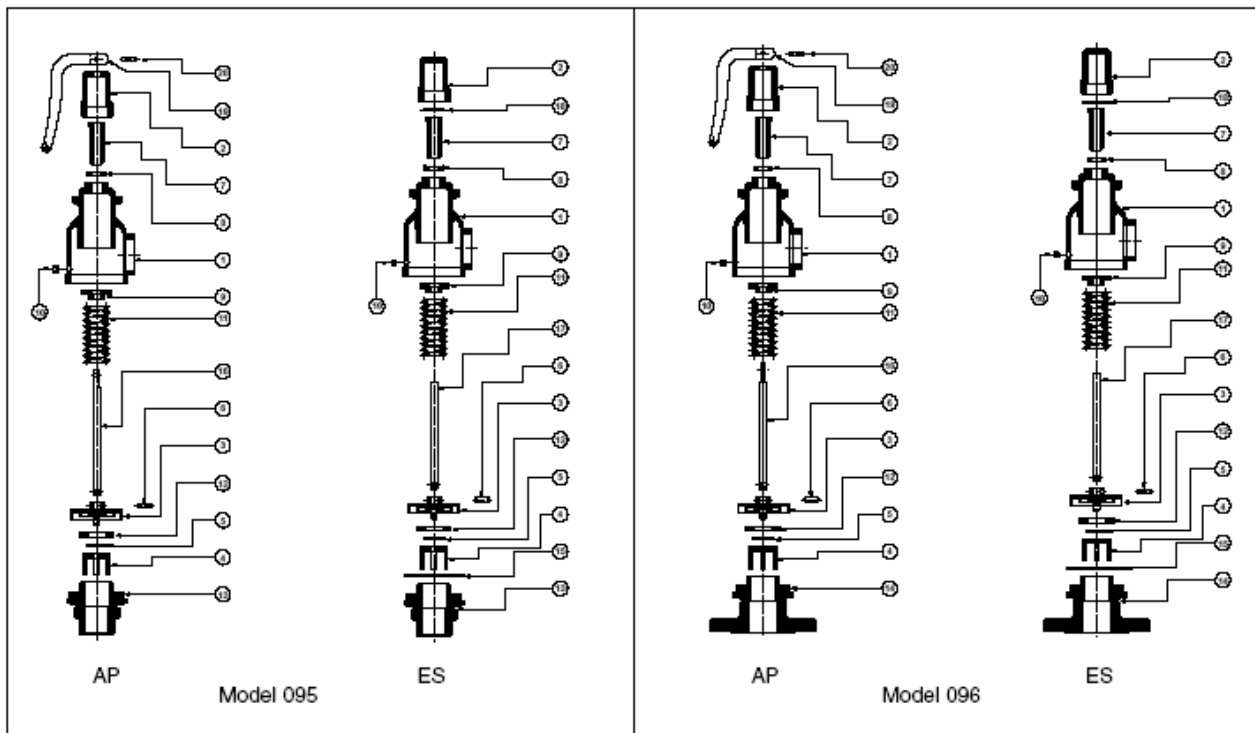

TYPE	N° PIECE	PIECE	R1 x R2	1/4" x 1/4"	3/8" x 3/8"	1/2" x 1/2"	3/4" x 3/4"	1" x 1"	1 1/4" x 1 1/4"	1 1/2" x 1 1/2"	2" x 2"	2 1/2" x 2 1/2"	3" x 3"	4" x 4"	PN	OPERATING CONDITIONS								
			DN1 x DN2	8 x 14"	10 x 38"	15 x 12"	20 x 34"	25 x 1"	32 x 1 1/4"	40 x 1 1/2"	50 x 2"	65 x 2 1/2"	80 x 3"	100 x 4"		A	B	C						
BRONZE / BRASS	1	Body	Brass (DIN-1.7660 CuZn 40Pb2)									*	Bronze (DIN-2.0492.01 G-CuZn 15S14)			16	16	200	-60					
	2	Cap	Brass (DIN-1.7660 CuZn 40Pb2)									*	Bronze (DIN-2.0492.01 G-CuZn 15S14)											
	3	Coupling	Brass (DIN-1.7660 CuZn 40Pb2)									Bronze (DIN-2.0492.01 G-CuZn 15S14)												
	4	Lead	Brass (DIN-1.7660 CuZn 40Pb2)									Bronze (DIN-2.0492.01 G-CuZn 15S14)												
	7	Hollow screw	Brass (DIN-1.7660 CuZn 40Pb2)																					
	8	Hollow screw nut	Brass (DIN-1.7660 CuZn 40Pb2)																					
	9	Spring press	Brass (DIN-1.7660 CuZn 40Pb2)																					
	10	Cap										Brass (DIN-1.7660 CuZn 40Pb2)												
	13	Screwed seat	Brass (DIN-1.7660 CuZn 40Pb2)									*	Bronze (DIN-2.0492.01 G-CuZn 15S14)											
	14	Flanged seat	Bronze (DIN-2.0492.01 G-CuZn 15S14)																					
	15	Body coupling	Klingerit cardboard																					
	18	Hood coupling	Copper																					
	MIXED	1	Body	Brass (DIN-1.7660 CuZn 40Pb2)									*	Bronze (DIN-2.0492.01 G-CuZn 15S14)						25	25	200	-60	
		2	Cap	Brass (DIN-1.7660 CuZn 40Pb2)									*	Bronze (DIN-2.0492.01 G-CuZn 15S14)										
		3	Coupling	Stainless steel (DIN-1.4401) (AISI-316)				Stainless steel (DIN-1.4408) (ASTM A351 CF8M)																
		4	Lead	Stainless steel (DIN-1.4408) (ASTM A351 CF8M)																				
		7	Hollow screw	Brass (DIN-1.7660 CuZn 40Pb2)																				
		8	Hollow screw nut	Brass (DIN-1.7660 CuZn 40Pb2)																				
9		Spring press	Brass (DIN-1.7660 CuZn 40Pb2)																					
10		Cap										Brass (DIN-1.7660 CuZn 40Pb2)												
13		Screwed seat	Stainless steel (DIN-1.4408) (ASTM A351 CF8M)																					
14		Flanged seat	Stainless steel (DIN-1.4408) (ASTM A351 CF8M)																					
15		Body coupling	PTFE (Teflon)																					
18		Hood coupling	Copper																					
STAINLESS STEEL		1	Body	Stainless steel (DIN-1.4408) (ASTM A351 CF8M)												25	25	250	-60					
		2	Cap	Stainless steel (DIN-1.4305) (AISI-303)				Stainless steel (DIN-1.4408) (ASTM A351 CF8M)																
		3	Coupling	Stainless steel (DIN-1.4401) (AISI-316)				Stainless steel (DIN-1.4408) (ASTM A351 CF8M)																
		4	Lead	Stainless steel (DIN-1.4408) (ASTM A351 CF8M)																				
		7	Hollow screw	Stainless steel (DIN-1.4305) (AISI-303)																				
		8	Hollow screw nut	Stainless steel (DIN-1.4305) (AISI-303)																				
	9	Spring press	Stainless steel (DIN-1.4301) (AISI-304)																					
	10	Cap										Stainless steel (DIN-1.4401) (AISI-316)												
	13	Screwed seat	Stainless steel (DIN-1.4408) (ASTM A351 CF8M)																					
	14	Flanged seat	Stainless steel (DIN-1.4408) (ASTM A351 CF8M)																					
	15	Body coupling	PTFE (Teflon)																					
	18	Hood coupling	PTFE (Teflon)																					
	5	Washer	Stainless steel (DIN-1.4401) (AISI-316)																					
	6	Clip	Stainless steel (DIN-1.4310) (AISI-301)																					
	11	Spring	Stainless steel (DIN-1.4300) (AISI-302) (1)																					
	12	Sealing disk	PTFE (Teflon)																					
			Silicone's rubber																					
			Fluorelastomer (Viton)																					
16,17	Rod	Stainless steel (DIN-1.4301) (AISI-304)																						
19	Lever	Stainless steel (DIN-1.4301) (AISI-304)				*	*	Brass (DIN-2.0290.01 G-Cu56Zn)																
20	Clip	Stainless steel (DIN-1.4301) (AISI-304)																						

(1) Spring steel (DIN-1.0600 GRADO B) for wide spring Ø > 10 mm. but < 14 mm.
Vanadium chrome steel (DIN-1.8159 50Cr V4) for wide spring Ø > 13 mm.

* Brass (DIN-2.0340.02 GK-Cu60Zn).
• Brass (DIN-1.7660 CuZn 40Pb2).

A = PRESSURE IN bar
B = MAX. TEMP. IN °C
C = MIN. TEMP. IN °C

DISASSEMBLY AND ASSEMBLY

1 – Disassembly

To replace the spring (11), or clean any of the internal components of the valve, proceed in the following manner:

- A – Withdraw the clip (20), using a punching tool, and lift the lever (19).
- B – Unscrew the cap (2) and remove.
- C – Holding the rod (16) (17) steady, loosen the hollow screw nut (8), until the constructive limit, and the hollow screw (7) until you note a releasing of the spring (11).
- D – Unscrew the body (1) holding the rod (16) (17) and the seat (13) (14) steady.
- E – Lift the body (1) and you will have access to all the components.

2 – Assembly

- A – Enter the body (1) and the joint (15) through the upper part the rod (16) (17).
- B – Turn the body (1) holding the rod (16) (17) and the seat (13) (14) steady.
- C – Replace the hollow screw (7) with the hollow screw nut (8).
- D – Adjust the set pressure with the hollow screw (7) and fix the adjustment position with the hollow screw nut (8).
- E – Change the coupling (18) and lightly tighten the cap (2).
- F – Place the lever (19) and fix it with the clip (20).

ADJUSTING THE SET PRESSURE

- A – Proceed according to DISASSEMBLY A, B, C.
- B – Proceed according to ASSEMBLY D, E, F.

WARNING

In case to do the change of the sealing disc (12) make sure that the surface of this as well as the one of the seat (13) (14) the correctly rectified and free of impurities.

R ₁ x R ₂ DN ₁ x R ₂		1/4" x 1/4"		8 x 1/4"		3/8" x 3/8"		1/2" x 1/2"		15 x 1/2"		3/4" x 3/4"		2 1/2 x 3/4"		1" x 1"		5 x 1"		1 1/4" x 1 1/4"		3/2 x 1 1/4"		1 1/2 x 1 1/2"		40 x 1 1/2"		2" x 2"		50 x 2"		2 1/2" x 2 1/2"		65 x 2 1/2"		3" x 3"		3/2 x 3"		4" x 4"		10 x 4"			
MODEL		065 AP 065 ES		089 AP 068 ES		065 AP 065 ES		089 AP 068 ES		065 AP 065 ES		065 AP 065 ES		065 AP 065 ES		065 AP 065 ES		065 AP 065 ES		065 AP 065 ES		065 AP 065 ES		065 AP 065 ES		065 AP 065 ES		065 AP 065 ES		065 AP 065 ES		065 AP 065 ES		065 AP 065 ES		065 AP 065 ES		065 AP 065 ES							
d ₀		10,20		10,20		10,20		16,20		16,20		20,80		20,80		25,20		25,20		32,20		32,20		38,20		38,20		45,20		45,20		60,20		60,20		75,20		75,20		95,20					
A ₀ = $\frac{\pi \cdot d_0^2}{4} - S$		29,50		29,50		29,50		120,30		120,30		207,50		207,50		347,10		347,10		548,00		548,00		780,40		780,40		1157,60		1157,60		2155,60		2155,60		3161,40		3161,40		5452,10					
H		139	129	148	136	139	129	148	138	150	140	165	155	168	158	179	168	191	181	188	188	224	212	282	282	263	247	270	254	301	315	394	318	378	348	378	348	439	415	441	417	507	483	507	483
h ¹		35		35		35		38		38		42		42		46		46		55		55		62		62		90		90		96		96		100		100		112					
L ₁		30		30		30		32		32		35		35		38		38		44		44		55		55		70		70		75		75		90		90		105					
L ₂		43	52	43	52	43	52	52	67	61	69	72	79	80	88	91	98	110	118	125	125	125	125	136	138	136	138	163	163	163	163	163	163	163	163	163	163	163	163	163	163	163	163		
R		-		-		-		-		-		-		-		-		-		-		-		-		-		-		1/8"		1/8"		1/8"		1/8"		1/8"		1/8"		1/8"			
CONNECTIONS		Whitworth cylindrical Male x Female thread ISO 228/1 1978 (DIN-259)																																											
INTAKE FLANGE		D ₁		-	80	-	90	-	95	-	105	-	115	-	140	-	150	-	165	-	185	-	200	-	220*	235*	-	180*	190*	-	18*	22*	-	24	-	24	-	24	-	24	-	24	-	24	
		K ₁		-	55	-	60	-	65	-	75	-	85	-	100	-	110	-	125	-	145	-	160	-	180*	190*	-	18*	22*	-	24	-	24	-	24	-	24	-	24	-	24	-	24		
		h ₁		-	11,50	-	14	-	14	-	14	-	14	-	18	-	18	-	18	-	18	-	18	-	18*	22*	-	18*	22*	-	24	-	24	-	24	-	24	-	24	-	24	-	24		
		b ₁		-	12	-	14	-	14	-	16	-	16	-	18	-	18	-	18	-	18	-	20	-	20	-	20	-	20	-	20	-	20	-	20	-	20	-	20	-	20	-	20		
		DRILLS N°:		-	4	-	4	-	4	-	4	-	4	-	4	-	4	-	4	-	4	-	4	-	4	-	4	-	4	-	4	-	4	-	4	-	4	-	4	-	4	-	4		
WEIGHT IN Kgs.		BRONZE/BRASS		0,60	0,60	0,80	0,80	1,00	1,00	1,25	1,25	1,50	1,50	1,80	1,80	2,20	2,20	2,80	2,80	3,40	3,40	4,20	4,20	5,00	5,00	6,00	6,00	7,50	7,50	9,00	9,00	10,80	10,80	12,00	12,00	15,00	15,00	18,00	18,00	21,00	21,00	25,00	25,00		
		MIXED		0,50	0,50	0,60	0,60	0,75	0,75	0,90	0,90	1,10	1,10	1,30	1,30	1,60	1,60	2,00	2,00	2,40	2,40	2,80	2,80	3,40	3,40	4,00	4,00	5,00	5,00	6,00	6,00	7,20	7,20	8,40	8,40	10,00	10,00	12,00	12,00	15,00	15,00				
		STAINLESS STEEL		0,80	0,80	1,00	1,00	1,25	1,25	1,50	1,50	1,80	1,80	2,20	2,20	2,80	2,80	3,40	3,40	4,20	4,20	5,00	5,00	6,00	6,00	7,50	7,50	9,00	9,00	10,80	10,80	12,00	12,00	15,00	15,00	18,00	18,00	21,00	21,00	25,00	25,00				
CODE		BRONZE/BRASS		2002-095.6043	2002-095.6041	2002-095.6043	2002-095.6041	2002-095.6043	2002-095.6041	2002-095.6043	2002-095.6041	2002-095.6043	2002-095.6041	2002-095.6043	2002-095.6041	2002-095.6043	2002-095.6041	2002-095.6043	2002-095.6041	2002-095.6043	2002-095.6041	2002-095.6043	2002-095.6041	2002-095.6043	2002-095.6041	2002-095.6043	2002-095.6041	2002-095.6043	2002-095.6041	2002-095.6043	2002-095.6041	2002-095.6043	2002-095.6041	2002-095.6043	2002-095.6041	2002-095.6043	2002-095.6041	2002-095.6043	2002-095.6041	2002-095.6043	2002-095.6041	2002-095.6043			
		MIXED		2002-095.6043	2002-095.6041	2002-095.6043	2002-095.6041	2002-095.6043	2002-095.6041	2002-095.6043	2002-095.6041	2002-095.6043	2002-095.6041	2002-095.6043	2002-095.6041	2002-095.6043	2002-095.6041	2002-095.6043	2002-095.6041	2002-095.6043	2002-095.6041	2002-095.6043	2002-095.6041	2002-095.6043	2002-095.6041	2002-095.6043	2002-095.6041	2002-095.6043	2002-095.6041	2002-095.6043	2002-095.6041	2002-095.6043	2002-095.6041	2002-095.6043	2002-095.6041	2002-095.6043	2002-095.6041	2002-095.6043	2002-095.6041	2002-095.6043	2002-095.6041	2002-095.6043			
		STAINLESS STEEL		2002-095.6043	2002-095.6041	2002-095.6043	2002-095.6041	2002-095.6043	2002-095.6041	2002-095.6043	2002-095.6041	2002-095.6043	2002-095.6041	2002-095.6043	2002-095.6041	2002-095.6043	2002-095.6041	2002-095.6043	2002-095.6041	2002-095.6043	2002-095.6041	2002-095.6043	2002-095.6041	2002-095.6043	2002-095.6041	2002-095.6043	2002-095.6041	2002-095.6043	2002-095.6041	2002-095.6043	2002-095.6041	2002-095.6043	2002-095.6041	2002-095.6043	2002-095.6041	2002-095.6043	2002-095.6041	2002-095.6043	2002-095.6041	2002-095.6043	2002-095.6041	2002-095.6043			

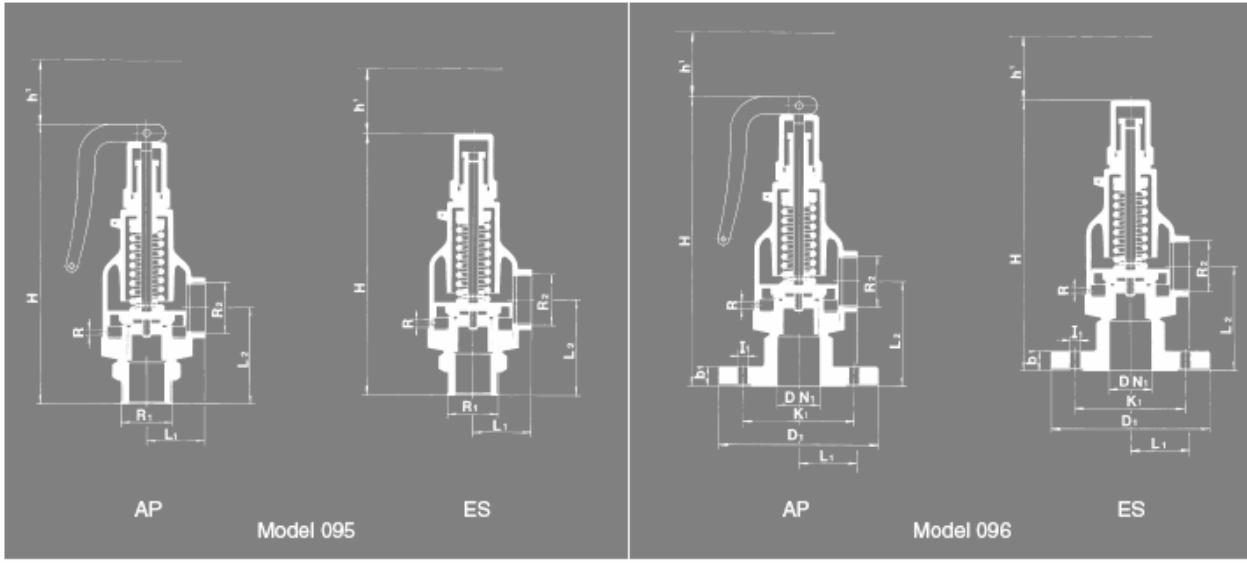

SET PRESSURES AND REGULATING RANGES								
R ₁ x R ₂ DN ₁ x R ₂	SPRING REGULATING RANGE IN bar	CODE	SET PRESSURES IN bar					
			MAXIMUM LIQUIDS AND GASES		MAXIMUM (SATURATED STEAM)		MINIMUM	
			PN-16	PN-25	PN-16	PN-25	STEAM & GASES	LIQUIDS (1)
1/4" x 1/4" 3/8" x 3/8" 8 x 1/4" 10 x 3/8"	0,5 at 1,0	56024 •	16	25	13	20	0,5	0,2
	1,1 at 1,9	56025 •						
	2,0 at 3,9	56026 •						
	4,0 at 7,9	56027 •						
	8,0 at 13,4	56028 •						
	13,5 at 19,8	56029 •						
	19,9 at 25,0	56030 •						
1/2" x 1/2" 15 x 1/2"	0,5 at 1,0	56033 •	16	25	13	20	0,5	0,2
	1,1 at 2,0	56034 •						
	2,1 at 4,0	56035 •						
	4,1 at 8,0	56036 •						
	8,1 at 12,0	56037 •						
	12,1 at 19,0	56038 •						
	19,1 at 25,0	56039 •						
3/4" x 3/4" 20 x 3/4"	0,5 at 1,0	56043 •	16	25	13	20	0,5	0,2
	1,1 at 2,0	56044 •						
	2,1 at 4,0	56045 •						
	4,1 at 6,0	56046 •						
	6,1 at 10,0	56047 •						
	10,1 at 13,2	56048 •						
	13,3 at 17,5	56049 •						
17,6 at 25,0	56050 •							
1" x 1" 25 x 1"	0,5 at 1,5	56053 •	16	25	13	20	0,5	0,2
	1,6 at 2,6	56054 •						
	2,7 at 4,0	56055 •						
	4,1 at 7,5	56056 •						
	7,6 at 11,0	56057 •						
	11,1 at 14,5	56058 •						
	14,6 at 20,0	56059 •						
20,1 at 25,0	56060 •							
1 1/4" x 1 1/4" 32 x 1 1/4"	0,5 at 1,5	56062 •	16	25	13	20	0,5	0,2
	1,6 at 2,6	56063 •						
	2,7 at 4,0	56064 •						
	4,1 at 7,5	56065 •						
	7,6 at 10,0	56066 •						
	10,1 at 12,5	56067 •						
	12,6 at 15,5	56068 •						
15,6 at 19,5	56069 •							
19,6 at 25,0	56070 •							
1 1/2" x 1 1/2" 40 x 1 1/2"	0,5 at 0,8	56073 •	16	25	13	20	0,5	0,2
	0,9 at 2,0	56074 •						
	2,1 at 4,0	56075 •						
	4,1 at 5,5	56076 •						
	5,6 at 8,0	56077 •						
	8,1 at 11,5	56078 •						
	11,6 at 15,7	56079 •						
15,8 at 25,0	56080 •							
2" x 2" 50 x 2"	0,5 at 1,0	56083 •	16	25	13	20	0,5	0,2
	1,1 at 2,0	56084 •						
	2,1 at 5,2	56085 •						
	5,3 at 6,7	56086 •						
	6,8 at 11,0	56087 •						
	11,1 at 13,8	56088 •						
	13,9 at 18,9	56089 •						
19,0 at 25,0	56090 -							
2 1/2" x 2 1/2" 65 x 2 1/2"	0,5 at 1,5	56092 •	16	25	13	20	0,5	0,2
	1,6 at 5,0	56093 •						
	5,1 at 9,0	56094 •						
	9,1 at 11,8	56095 -						
	11,9 at 15,0	56096 -						
	15,1 at 19,0	56097 -						
	19,1 at 25,0	56098 ▲						
3" x 3" 80 x 3"	0,5 at 2,0	56099 •	16	25	13	20	0,5	0,2
	2,1 at 6,0	56100 •						
	6,1 at 8,8	56101 -						
	8,9 at 12,0	56102 ▲						
	12,1 at 18,5	56103 ▲						
	18,6 at 21,5	56104 ▲						
	21,6 at 25,0	56105 ▲						
4" x 4" 100 x 4"	0,5 at 2,0	56106 •	16	25	13	20	0,5	0,2
	2,1 at 6,0	56107 -						
	6,1 at 9,0	56108 ▲						
	9,1 at 14,0	56109 ▲						
	14,1 at 19,0	56110 ▲						
	19,1 at 25,0	56111 ▲						

• Stainless steel (DIN-1.4300) (AISI-302).
 - Spring steel with Epoxid coating (DIN-1.0600 GRADE B).
 ▲ Vanadium chrome steel with Epoxid coating (DIN-1.8159 50CrV4).
 (1) For set pressures less than 0,5 bar previous consult with our technical department.

COEFFICIENT OF DISCHARGE

R1 x R2 DN1 x R2	1/4" x 1/4" 8 x 1/4"	3/8" x 3/8" 10 x 3/8"	1/2" x 1/2" 15 x 1/2"	3/4" x 3/4" 20 x 3/4"	1" x 1" 25 x 1"	1 1/4" x 1 1/4" 32 x 1 1/4"	1 1/2" x 1 1/2" 40 x 1 1/2"	2" x 2" 50 x 2"	2 1/2" x 2 1/2" 65 x 2 1/2"	3" x 3" 80 x 3"	4" x 4" 100 x 4"
d	10,20	10,20	16,20	20,80	25,20	32,20	38,20	45,20	60,20	75,20	95,20
h	2,50	2,50	3,00	5,00	6,00	8,50	11,00	12,00	15,00	19,00	28,00
h/d0	0,25	0,25	0,19	0,24	0,24	0,26	0,29	0,27	0,25	0,25	0,29
$A_0 = \frac{\pi \cdot d_0^2}{4} - S$	29,50	29,50	120,90	207,50	347,10	549,00	790,40	1157,60	2155,60	3161,40	5452,10

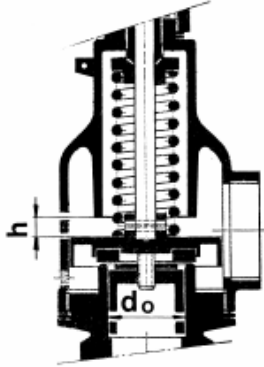

$$A_0 = \frac{\pi \cdot d_0^2}{4} - S$$

S = Lead section

RECOMMENDED RANGES OF APPLICATION

MODEL		AP	ES
FLUID	SATURATED STEAM	*	
	GASES	* (1)	*
	LIQUIDS	* (1)	*

- (1) With noxious or expensive fluids apply only ES model.
 If external overpressure exists, the AP model cannot be used.
 With external constant overpressure, the spring is adjusted deducting the overpressure from the set pressure.

DISCHARGE CAPACITY

R1 x R2 DN1 x R2	1/4" x 1/4" 8 x 1/4"	3/8" x 3/8" 10 x 3/8"	1/2" x 1/2" 15 x 1/2"	3/4" x 3/4" 20 x 3/4"	1" x 1" 25 x 1"	1 1/4" x 1 1/4" 32 x 1 1/4"
d0	10,2	10,2	16,2	20,8	25,2	32,2
$A_0 = \frac{\pi \cdot d_0^2}{4} - S$	29,50	29,50	120,3	207,5	347,1	543

p [bar]	For other, not so dense liquids, other than water at 20°C apply:																	
	I - Saturated steam in Kg/h.			II - Air at 0°C and 1,013 bar in [Nm³/h].			III - Water at 20°C in l/h.			$V_L = \sqrt{\frac{Q_A}{Q_L}} \cdot V_A \text{ ó } V_A = V_L \sqrt{\frac{Q_L}{Q_A}}$								
SET PRESSURE IN bar	I	II	III	I	II	III	I	II	III	I	II	III	I	II	III	I	II	III
0,5	25	30	342	25	30	342	42	53	514	51	62	737	58	88	1096	65	123	1290
1,0	39	45	489	39	45	489	63	80	785	77	94	1053	88	133	1490	99	185	1944
1,5	42	51	582	42	51	582	68	94	857	86	106	1228	95	147	1674	114	227	2015
2,0	45	57	675	45	57	675	74	108	980	96	118	1403	102	161	1899	130	270	2187
2,5	50	66	768	50	66	768	83	120	1100	113	131	1590	121	180	2020	152	310	2707
3,0	54	75	861	54	75	861	91	133	1221	130	143	1778	140	199	2170	175	350	3227
3,5	60	85	955	60	85	955	110	145	1342	138	159	1944	154	233	2350	223	387	3468
4,0	66	96	1050	66	96	1050	129	157	1463	143	175	2110	168	258	2530	272	425	3710
4,5	70	106	1127	70	106	1127	137	173	1619	155	197	2282	195	282	2802	298	461	4130
5,0	75	117	1204	75	117	1204	146	190	1775	167	219	2455	222	306	3075	305	497	4551
5,5	79	127	1281	79	127	1281	155	206	1931	179	241	2627	249	310	3347	322	533	4971
6,0	84	138	1359	84	138	1359	164	223	2088	192	264	2800	276	325	3620	339	570	5392
6,5	87	148	1428	87	148	1428	171	255	2191	208	288	2902	300	341	3780	361	606	5800
7,0	91	159	1497	91	159	1497	178	287	2294	224	314	3004	324	358	3940	383	642	5988
7,5	95	169	1566	95	169	1566	185	319	2397	240	339	3106	348	375	4100	405	678	6286
8,0	99	180	1635	99	180	1635	192	352	2500	258	365	3208	372	392	4260	427	715	6584
9,0	107	204	1740	107	204	1740	226	376	2670	286	417	3404	412	442	4588	491	767	7282
10,0	115	228	1845	115	228	1845	260	400	2840	336	470	3600	458	493	4916	558	820	8000
11,0	123	252	1957	123	252	1957	300	426	3000	397	517	3790	506	541	5142	622	890	9010
12,0	132	276	2070	132	276	2070	340	452	3160	439	565	3960	560	590	5388	689	960	10020
13,0	139	301	2187	139	301	2187	372	476	3324	482	607	4102	602	655	5620	732	1042	10535
14,0	147	327	2285	147	327	2285	405	500	3488	526	650	4244	645	720	6272	778	1125	11050
15,0	154	349	2341	154	349	2341	442	526	3624	548	697	4402	693	790	6481	838	1202	11525
16,0	162	372	2418	162	372	2418	480	552	3760	570	745	4560	721	800	6690	900	1290	12000
17,0	169	396	2521	169	396	2521	520	572	3890	610	822	4750	796	883	6945	970	1360	12330
18,0	177	420	2625	177	420	2625	560	592	4020	650	920	4940	872	967	7200	1040	1440	12690
20,0	192	465	2829	192	465	2829	640	644	4360	725	1016	5076	956	1190	7740	1190	1600	13316
22,0		510	3036		510	3036		696	4652		1112	5092		1310	8216		1772	13976
24,0		544	3190		544	3190		750	4808		1184	5418		1415	8598		1896	14580
25,0		579	3345		579	3345		805	4964		1258	5740		1520	8990		2020	15144

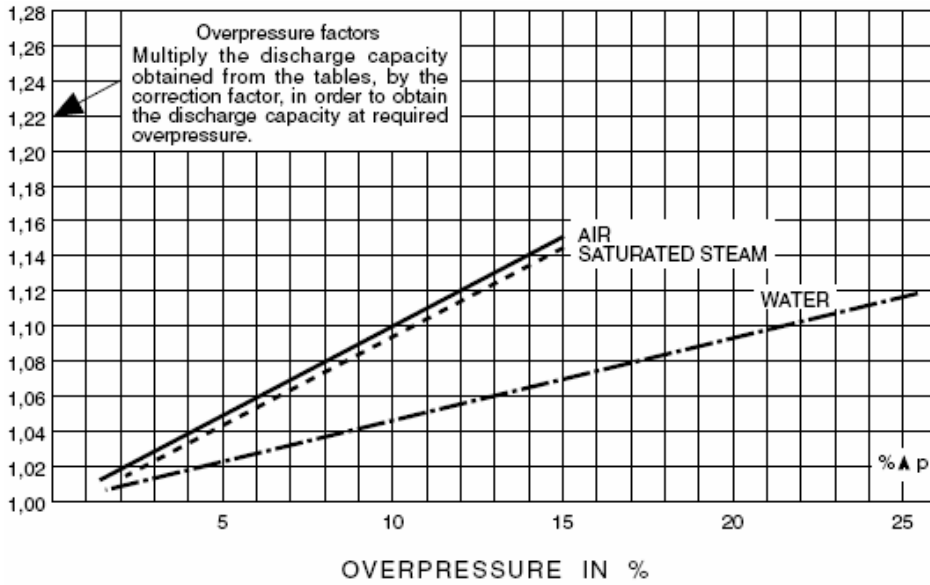

DISCHARGE CAPACITY															R1 x R2 DN1 x R2
1 1/2" x 1 1/2" 40 x 1 1/2"			2" x 2" 50 x 2"			2 1/2" x 2 1/2" 65 x 2 1/2"			3" x 3" 80 x 3"			4" x 4" 100 x 4"			
38,2			45,2			60,2			75,2			95,2			p [bar]
780,4			1157,6			2155,6			3161,4			5452,1			
I	II	III	I	II	III	I	II	III	I	II	III	I	II	III	
104	176	1930	146	225	2998	189	272	4130	272	335	5201	484	656	6472	0,5
157	266	2758	220	339	4140	284	410	5900	410	505	7430	729	987	9247	1,0
176	310	3242	250	385	4829	318	458	6765	455	557	8307	850	1050	10141	1,5
196	359	3727	290	430	5117	351	507	7690	500	609	9184	972	1119	11005	2,0
234	391	4148	308	475	5540	385	565	8490	554	705	9992	1087	1202	11920	2,5
273	430	4570	336	521	5984	419	623	9350	609	802	10800	1203	1292	11604	3,0
308	469	4931	375	586	6788	454	686	11315	667	861	12453	1326	1376	13742	3,5
343	497	5292	415	652	7612	490	749	13290	725	920	14107	1449	1490	15890	4,0
384	557	5841	444	709	8134	532	809	14895	786	1024	15610	1567	1586	17756	4,5
385	618	6591	473	768	10656	575	870	16090	847	1128	17113	1686	1712	19632	5,0
406	679	7240	502	823	12178	617	931	17495	908	1232	18616	1804	1838	21508	5,5
427	740	7890	532	890	13700	660	992	18900	969	1336	20120	1923	1964	23384	6,0
452	796	8224	570	919	14697	681	1030	19338	1027	1420	20852	2042	2056	23910	6,5
478	832	8559	609	958	15674	702	1068	19776	1086	1504	21585	2161	2148	24437	7,0
503	878	8983	648	997	16661	723	1106	20214	1144	1588	22317	2290	2240	24963	7,5
529	925	9228	687	1036	17648	744	1145	20653	1203	1672	23060	2400	2332	25490	8,0
564	1014	10958	711	1106	19539	802	1215	22812	1327	1854	24373	2641	2414	26081	9,0
600	1104	12988	735	1176	21430	860	1285	24972	1452	2036	25696	2883	2496	26672	10,0
675	1188	13374	807	1258	22365	923	1388	25311	1576	2218	26968	3121	2714	27464	11,0
750	1272	14060	879	1340	23300	967	1492	25650	1700	2390	28240	3360	2922	28256	12,0
806	1358	14715	957	1430	24070	1056	1596	26525	1822	2577	27905	3601	3144	29108	13,0
882	1445	15370	1036	1520	24840	1125	1690	27400	1944	2765	28370	3843	3356	29960	14,0
957	1530	16310	1104	1615	25684	1190	1836	27915	2076	2948	29033	4086	3604	30650	15,0
1052	1615	17250	1172	1710	26529	1256	1992	28430	2209	3132	29697	4329	3852	31340	16,0
1124	1708	17945	1251	1877	27300	1374	2186	29575	2325	3294	31032	4566	4222	32592	17,0
1196	1792	18640	1330	2045	28072	1493	2390	30720	2442	3456	32368	4803	4592	33244	18,0
1292	1965	20230	1452	2385	29970	1590	2512	32456	2685	3812	33090	5295	5182	34836	20,0
	2232	21969		2556	31296		2952	35200		4156	36616		5750	38120	22,0
	2374	22090		2786	32590		3198	38098		4404	42400		6103	46320	24,0
	2516	22212		2976	33985		3424	40976		4652	48184		6456	54520	25,0

Calculus and measurement according "DIN-A4-109268/69/70"

FACT LIST FOR SAFETY VALVE CALCULS Calculus according to AD-Merkblatt A2 SR, "Safety valve" 1)			Customer:			
			Theme:			
			Leaf:	Of:		
1	Consultation / Bid / Order					
2	Position N°:					
3	N° of units					
4	Regulation					
5	SERVICE CONDITIONS	Fluid				
6		Calculation temperature °C				
7		State at moment of dischar. l = liquid, s = steam, g = gas				l <input type="checkbox"/> s <input type="checkbox"/> g <input type="checkbox"/>
8		Molecular mass kg/kmol				
9		Adiabatic exponent æ		Compressibility coe. Z		
10		Density at moment of discharge kg/m³				
11		Coefficients Ψ max		Z		
12		Viscosity cSt		cPs		
13		Working pressure abs. bar				
14		Set pressure abs. bar				
15		External back pressure abs.				
			constant	variable	bar	
16		Rated pressure abs. bar				
17		Discharge		Required: kg/h, Nm³/h, l/h		
18	capacity		Possible: 1) Kg/h, Nm³/h, l/h			
19	Opening: Full lift / Normal / Progressive					
20	Manufacturer type					
21	MATERIALS	Body				
22		Seat				
23		Plug				
24		Spring				
25		Joint				
26	Manual discharge action yes / no					
27	Cover Closed / Open					
28	Bellows yes / no					
29	Body with drainage yes / no					
30	Diameter of narrowest flow d _b mm					
31	Section of narrowest		Necessary A _o mm²			
32	flow A _o		Chosen A _o mm²			
33	Allowed discharge coefficient α _d					
34	CONNECTIONS	Input / Output	DN		Flange mm	
35					Thread inch	
36					Welding (soldering) ends	
37		PN		bar		
38	Shape of joint surfaces (DIN-2526)					
39	OBSERVATIONS	Unit weight approx. Kg				
40						
41						
42						
43	ACCEPTANCE	Certificate according to DIN - 50049 2.2				
44		Certificate according to DIN - 50049 3.1.B				
45						
Date:						
Department:						
Name:						

Informative brochure, without obligation and subject to our General Sales Conditions.